

vtech[®]
Baby

User's Manual

Toot-Toot Friends

Helpful Hospital



© 2015 VTech
Printed in China
91-003100-001 UK

VTech understands that a child's needs and abilities change as they grow and with that in mind we develop our toys to teach and entertain at just the right level...

Pre-School

Interactive toys to develop their imagination and encourage language development

vtech Baby

Toys that will stimulate their interest in different textures, sounds and colours

I am...

...responding to colours, sounds and textures

...understanding cause and effect

...learning to touch, reach, grasp, sit-up, crawl and toddle

Birth-36 months



I want...

...to get ready for school by starting to learn the alphabet and counting

...my learning to be as fun, easy and exciting as can be

...to show my creativity with drawing and music so my whole brain develops

3-6 years



Electronic Learning Computers

Cool, aspirational and inspiring computers for curriculum related learning

I need...

...challenging activities that can keep pace with my growing mind

...intelligent technology that adapts to my level of learning

...National Curriculum based content to support what I'm learning at school

4-10 years



To learn more about this and other VTech® products, visit www.vtech.co.uk

INTRODUCTION

Thank you for purchasing the **VTech® Toot-Toot Friends Helpful Hospital!**

Welcome to the **Toot-Toot Friends Helpful Hospital** by VTech®. Friends and the hospital come to life with 3 **MagicPoint** locations as you explore each room in this two-story interactive hospital. Take a rest on the bench, visit the doctor's office and more!

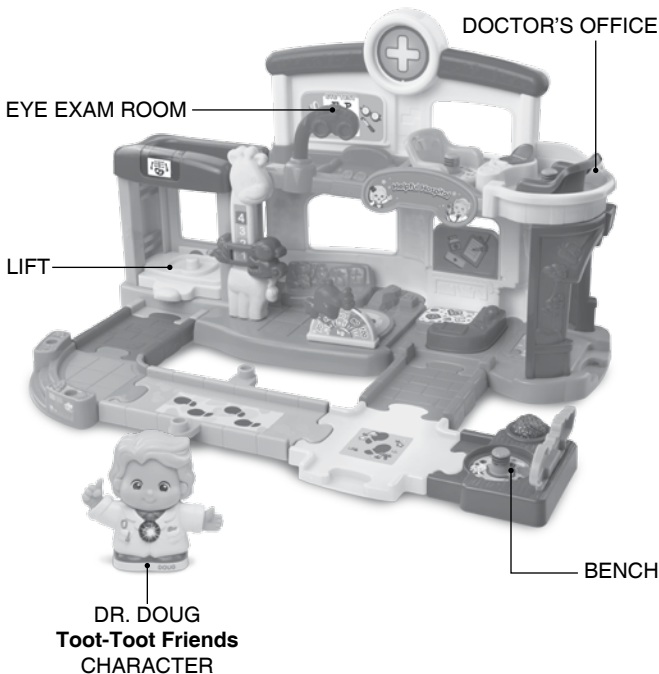

INCLUDED IN THIS PACKAGE

NOTE: This toy is not intended for teething.

- One **VTech® Toot-Toot Friends** character
- One crocodile bench with **MagicPoint** location
- One 1st floor base
- One 2nd floor base with 2 **MagicPoint** locations

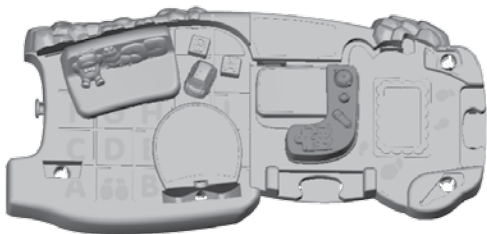

INCLUDED IN THIS PACKAGE

- One 1st floor wall
- One 2nd floor wall

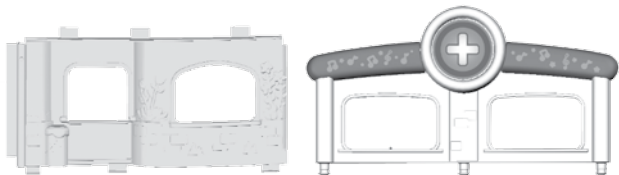

- One entrance archway
- One lift
- One height measurer



- One scale
- One eye exam machine
- One pharmacy counter piece



- One long walkway track
- One cross walkway track
- One 90-degree walkway track, male
- Two short walkway tracks

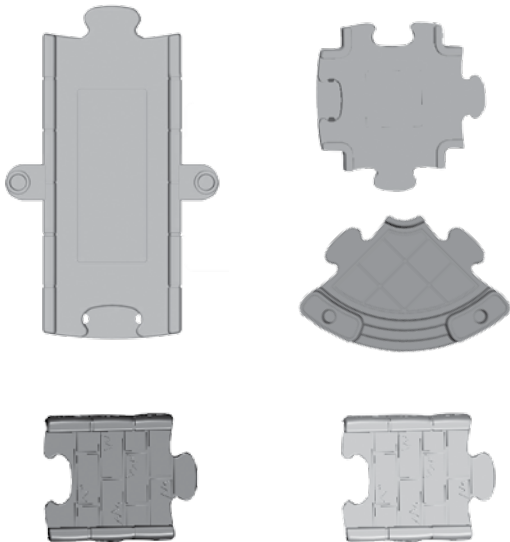

INCLUDED IN THIS PACKAGE

- One label sheet



- One user's manual

Unlock the packaging lock:

There is one packaging lock located on the character.

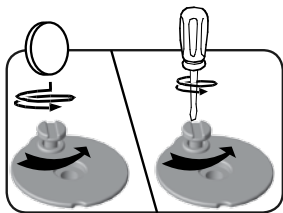

- ① Use a coin or a screwdriver to loosen the screw.
- ② Pull out and discard the screw and packaging lock.

WARNING:

All packing materials, such as tape, plastic sheets, packaging locks and tags are not part of this toy, and should be discarded for your child's safety.

NOTE:

Please keep the user's manual as it contains important information.

GETTING STARTED

BATTERY INSTALLATION

1. Make sure the unit is **OFF**.
2. Locate the battery cover on the bottom of the unit. Use a screwdriver to loosen the screws.
3. Install 2 new AAA size (LR03/AM-4) batteries following the diagram inside the battery box. (The use of new alkaline batteries is recommended for maximum performance.)
4. Replace the battery cover and tighten the screws to secure.

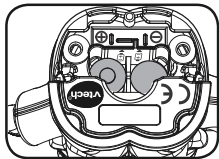
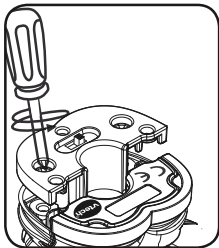

ACTIVATE NORMAL PLAY MODE

This product is in a try-me mode in the packaging. To activate normal play mode, please complete the following steps:

1. Slide the **ON/OFF SWITCH** to the **OFF** (●) position.
2. Press and hold the **LIGHT-UP BUTTON** for 2 seconds.
3. Slide the **ON/OFF SWITCH** to the **ON** (⬢) position to activate normal play mode.

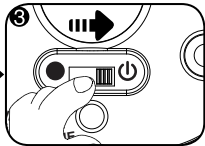
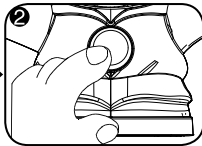
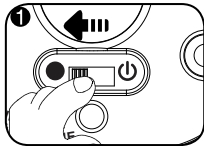

BATTERY NOTICE

- Use new alkaline batteries for maximum performance.
- Use only batteries of the same or equivalent type as recommended.
- Do not mix different types of batteries: alkaline, standard (carbon-zinc) or rechargeable (Ni-Cd, Ni-MH), or new and used batteries.
- Do not use damaged batteries.
- Insert batteries with the correct polarity.
- Do not short-circuit the battery terminals.
- Remove exhausted batteries from the toy.
- Remove batteries during long periods of non-use.
- Do not dispose of batteries in fire.
- Do not charge non-rechargeable batteries.
- Remove rechargeable batteries from the toy before charging (if removable).
- Rechargeable batteries are only to be charged under adult supervision.

Disposal of batteries and product

The crossed-out wheelie bin symbols on products and batteries, or on their respective packaging, indicates they must not be disposed of in domestic waste as they contain substances that can be damaging to the environment and human health.

The chemical symbols Hg, Cd or Pb, where marked, indicate that the battery contains more than the specified value of mercury (Hg), cadmium (Cd) or lead (Pb) set out in Battery Directive (2006/66/EC).



The solid bar indicates that the product was placed on the market after 13th August, 2005.



Help protect the environment by disposing of your product or batteries responsibly.

For more information, please visit:

www.recycle-more.co.uk

www.recyclenow.com

ASSEMBLY INSTRUCTIONS

With the **VTech® Toot-Toot Friends Helpful Hospital**, safety comes first. To ensure your child's safety, adult assembly is required.

1. Attach the pharmacy counter piece to the 1st floor wall as shown in the picture.
2. Attach the 1st floor wall, entrance archway, height measurer and scale to the 1st floor base as shown in the picture. You will hear a click sound indicating the pieces are secure.
3. Attach the 2nd floor wall to the 2nd floor base as shown in the picture. You will hear a click sound indicating the pieces are secure.
4. Attach the 2nd floor and the lift to the 1st floor as shown in the picture. You will hear a click sound indicating the pieces are secure.

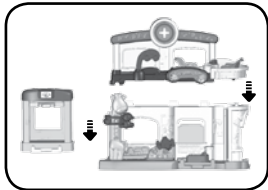
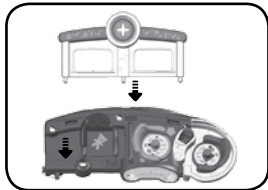
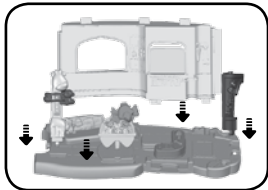
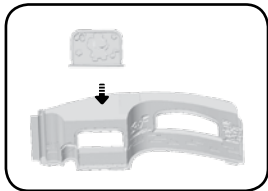

5. After the above steps, you can connect the assembled hospital and the bench to the included walkway track pieces. You can configure them into different arrangements.

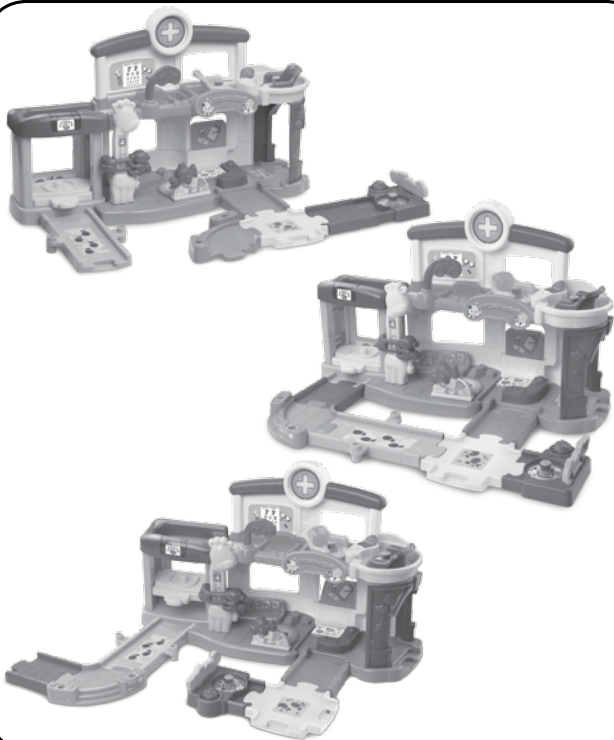

LABEL APPLICATION

Please stick the labels to the playset securely as indicated below.



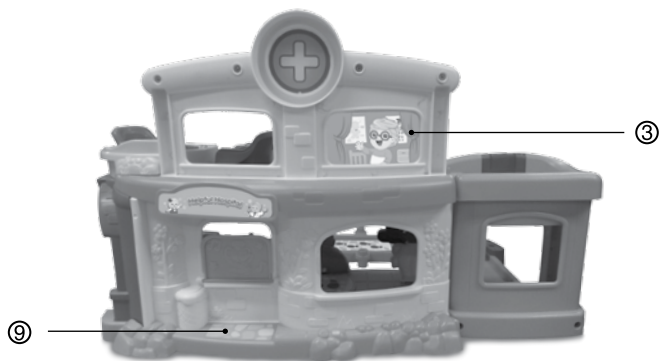
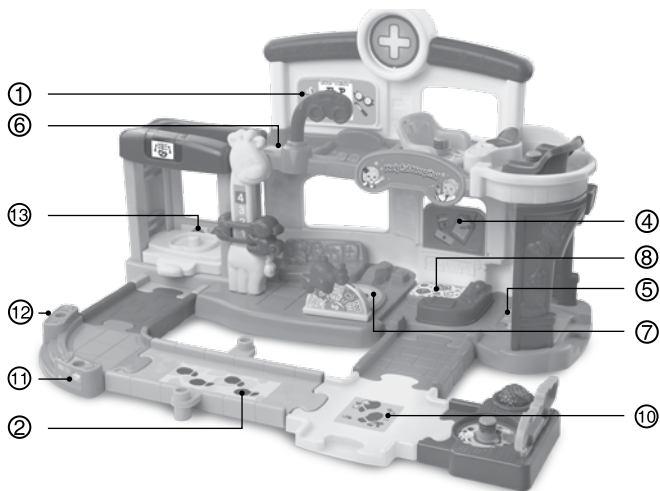

PRODUCT FEATURES

1. ON/OFF SWITCH

The **ON/OFF SWITCH** is located on the bottom of the character.

To turn the unit on, slide the **ON/OFF SWITCH** to the **ON** (⬆) position. To turn the unit off, slide the **ON/OFF SWITCH** to the **OFF** (●) position.

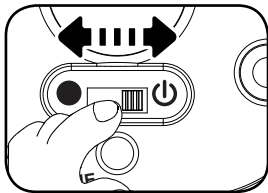

2. AUTOMATIC SHUT-OFF

To preserve battery life, the **VTech® Toot-Toot Friends** character will automatically power down after several minutes of no input. The unit can only be turned on again by pressing the **LIGHT-UP BUTTON** or placing it on a **MagicPoint** location.

ACTIVITIES – CHARACTER

1. Slide the **ON/OFF SWITCH** to turn the unit **ON**. Then press the **LIGHT-UP BUTTON** to hear voices, songs, melodies and fun sounds.

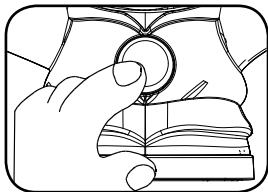

2. Place the character on one of the playset's three **MagicPoint** locations to hear phrases, fun sounds, short tunes, and sing-along songs. Some of the **MagicPoint** locations can even turn on the playset's lights. The character can also interact with other **Toot-Toot Friends** playsets (each sold separately).

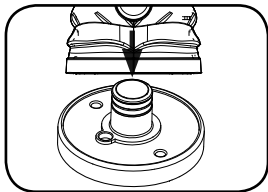

ACTIVITIES - HELPFUL HOSPITAL

1. Place the character on the **BENCH**'s **MagicPoint** location to help him take a rest and to turn on the bench's light.



2. Place the character on the **DOCTOR'S CHAIR** **MagicPoint** to light up the computer and to hear him talk and sing.



3. Place the character on the **PATIENT'S CHAIR** **MagicPoint** to pretend he is visiting a doctor.



MOTOR SKILLS DEVELOPMENT - HELPFUL HOSPITAL

There are lots of fun things in the **Helpful Hospital** that you can explore to help develop fine motor skills.

1. Move the **EYE EXAM MACHINE** to help check the character's eyes.



2. Place the character on the **LIFT** and move it up and down to transfer the character to different floors of the hospital.

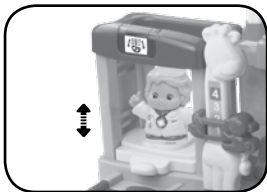

3. Move the **HEIGHT MEASURER SLIDER** to see how tall the character is!



4. Move the **SCALE** to check the character's weight.



5. Move the **PHARMACY COUNTER PIECE** up & down to locate the medicine.



CARE & MAINTENANCE

1. Keep the unit and its metal parts clean by wiping them with a slightly damp cloth.
2. Keep the unit out of direct sunlight and away from any direct heat sources.
3. Remove the batteries when the unit is not in use for an extended period of time.
4. Do not drop the unit on a hard surface and do not expose the unit to excess moisture or water.

TROUBLESHOOTING

If for some reason the unit stops working or malfunctions while playing with a **MagicPoint** accessory, please remove the character from the accessory and place the character back onto the **MagicPoint**.

If the unit still does not function, or if for some reason the unit stops working or malfunctions on its own, please follow these steps:

1. Please turn the unit **OFF**.
2. Interrupt the power supply by removing the batteries.
3. Let the unit stand for a few minutes, then replace the batteries.
4. Turn the unit **ON**. The unit should now be ready to play again.
5. If the product still does not work, replace with a new set of batteries.

If the problem persists, please call our Consumer Services Department on 01235 546810 (from UK) or +44 1235 546810 (outside UK) and a service representative will be happy to help you.

IMPORTANT NOTE:

Creating and developing **VTech®** products is accompanied by a responsibility that we take very seriously. We make every effort to ensure the accuracy of the information which forms the value of our products. However, errors sometimes can occur. It is important for you to know that we stand behind our products and encourage you to call our Consumer Services Department at 01235 546810 (from UK) and +44 1235 546810 (outside UK) with any problems and/or suggestions that you might have. A service representative will be happy to help you.

**CLASS 1
LED PRODUCT**



PRODUCT WARRANTY



Thank you for choosing this quality product from VTech. We hope it will bring many hours of entertainment, imaginative play and learning.

1. The product detailed above is covered by a one year warranty from the date of purchase, against any defects in materials or workmanship.
2. The product may be returned to the place of purchase. Alternatively the product can be returned to VTech Electronics Europe plc (see address below), with proof of purchase, without proof of purchase no replacement will be provided.
3. VTech Electronics Europe plc will examine the product and if it is found to be defective due to faulty materials or workmanship, will replace the product at their discretion.
4. If the product covered by this warranty is damaged due to misuse, modification or unauthorised repair, or because of faulty batteries, battery discharge or incorrect electrical connections, then this warranty becomes void.
5. This warranty is personal to the original purchaser and is not transferable.
6. Breakages to the LCD screen are not covered by the warranty.
7. Returns to VTech Electronics Europe plc should include a cheque or postal order for £1.50 towards the cost of return postage and packaging.
8. Products returned to VTech Electronics Europe plc, should be addressed as follows and packed carefully to avoid damage in transit (Please do not include batteries or adaptor).
Please include details of the fault together with your name and address.
9. To keep an online record of your warranty, please register your product online at www.vtech.co.uk/warranty

VTech Electronics Europe plc, c/o Tablogix Limited, 200 Milton Park, Abingdon, Oxon OX14 4TA

THIS WARRANTY IS OFFERED AS AN EXTRA BENEFIT AND DOES NOT AFFECT CONSUMERS' STATUTORY RIGHTS.

This warranty is valid for the UK and Eire only. For products purchased outside the UK and Eire, please contact your local distributor or place of purchase.